

# playmobil®

## 70191



### WARNING: CHOKING HAZARD

Small parts. Not for children under 3 years.

"Ne concerne que les USA"

Wichtige Unterlagen, bitte sorgfältig aufbewahren!  
Important: Please keep these instructions for future reference!  
Documents importants, à conserver soigneusement!  
Belangrijke documenten, bewaar deze zorgvuldig!

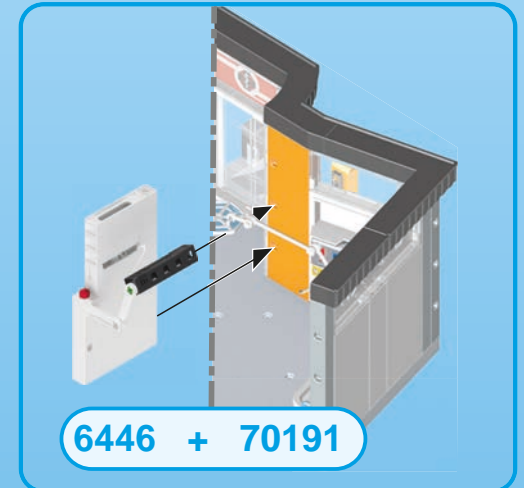

**UK-Importer:**  
**Playmobil UK Ltd.**  
Regency House  
1 Miles Gray Road  
Basildon  
Essex  
SS14 3RW  
UK

**UK  
CA**

Serviceadressen finden Sie in allen  
PLAYMOBIL-Prospekten

Addresses of Customer Service Depart-  
ments are shown in all PLAYMOBIL  
catalogues

L'adresse du service consommateurs  
est indiquée dans tous les catalogues  
PLAYMOBIL

Troverete gli indirizzi dei centri di  
assistenza in tutti i cataloghi PLAYMOBIL

In alle PLAYMOBIL catalogi vindt u  
het adres van onze klantendienst.

Las Direcciones de los Departamentos  
de Servicio al Consumidor se encuentran  
en todos los catálogos PLAYMOBIL

Η διεύθυνση του Γραφείου Εξυπηρέτησης  
Καταναλωτών PLAYMOBIL βρίσκεται σε  
όλους τους καταλόγους PLAYMOBIL.

pronounced: plāy-mō-bēil

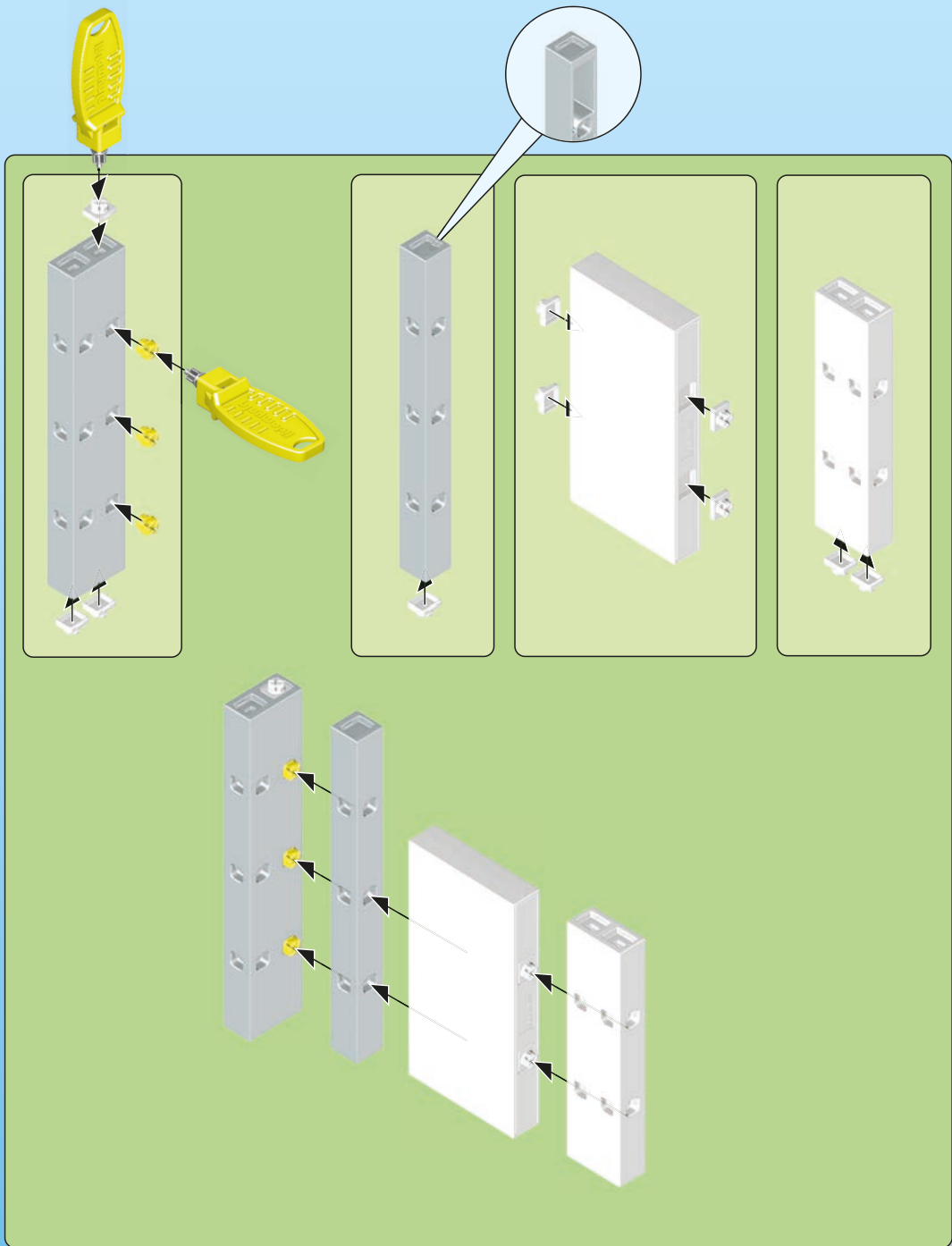

1

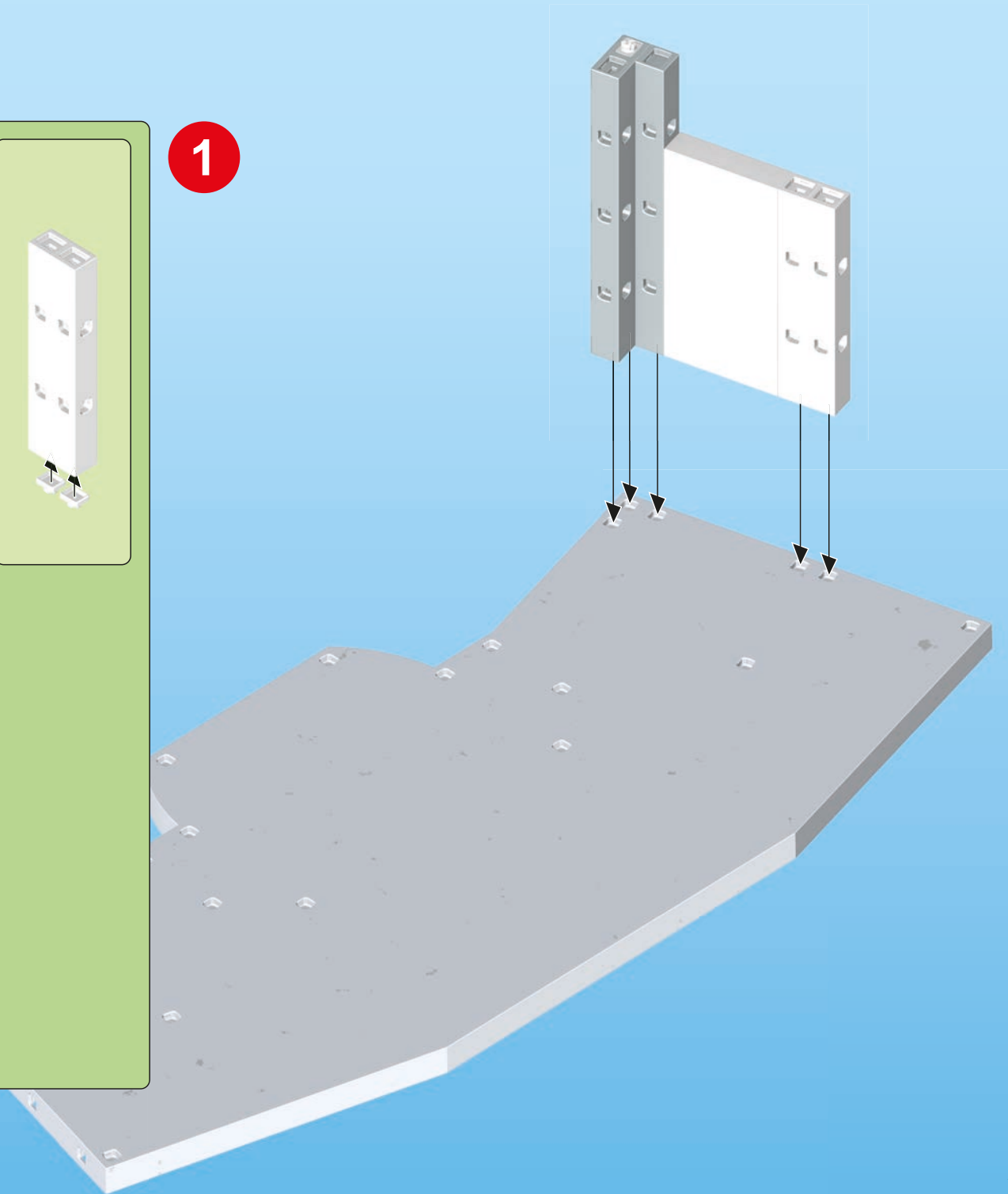

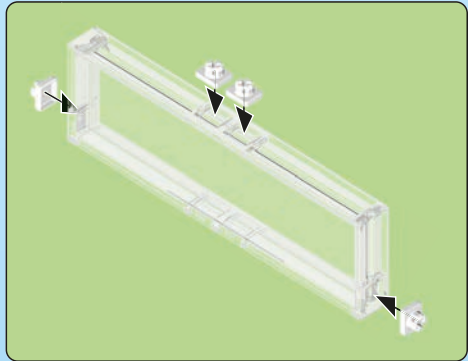

2

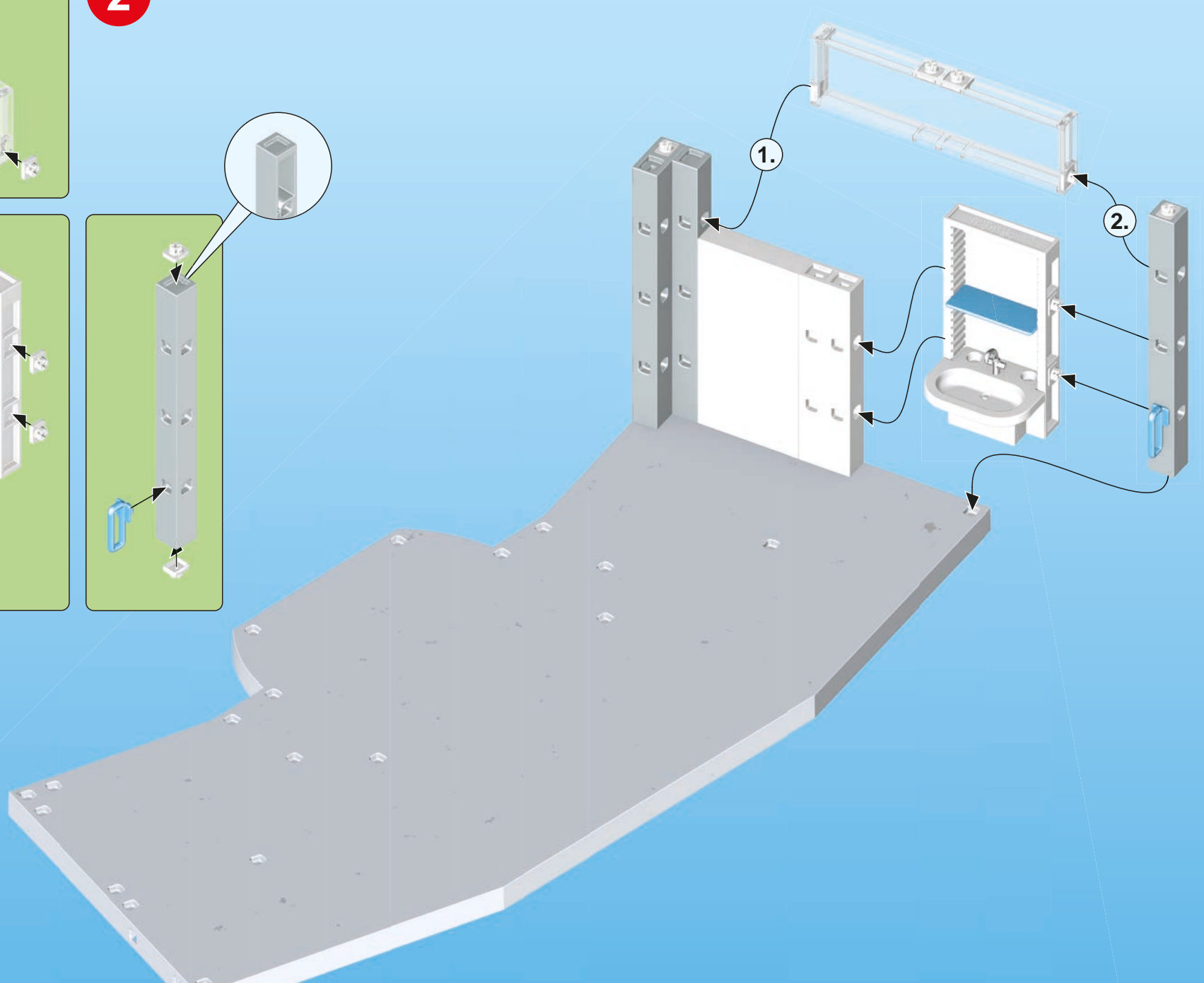
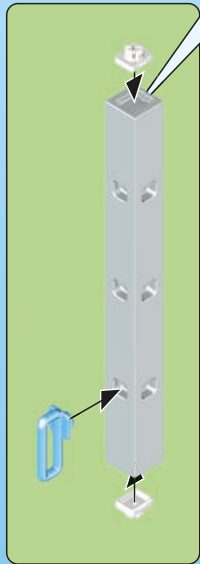
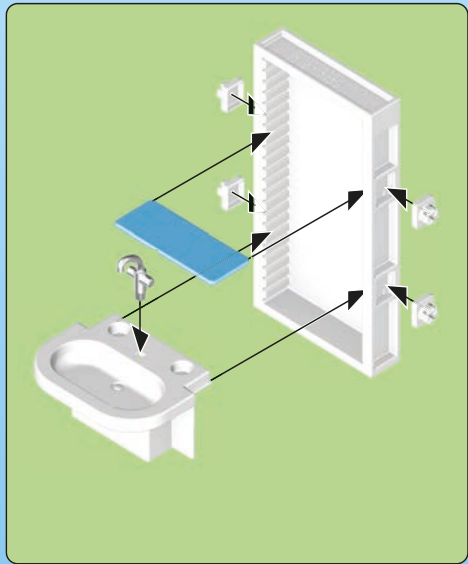



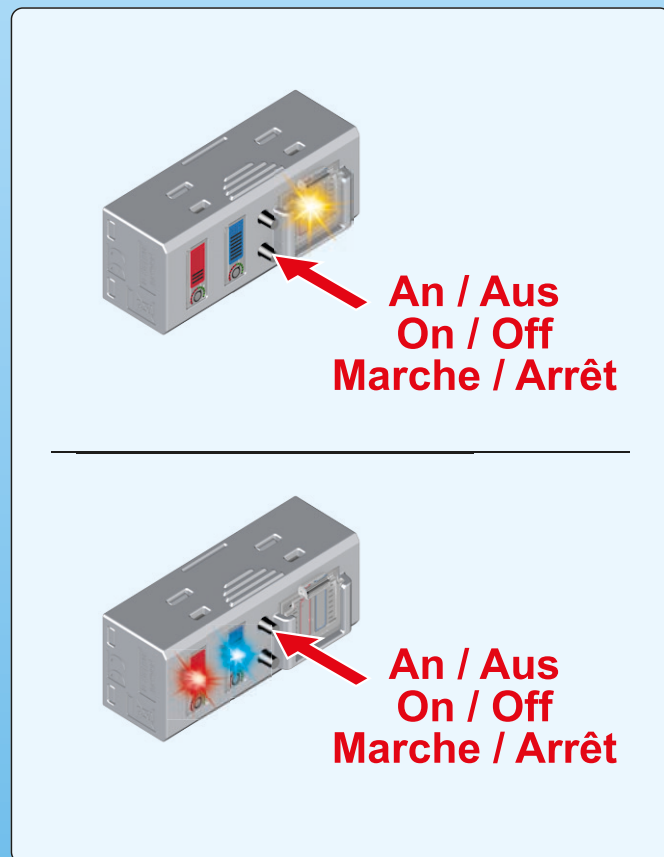
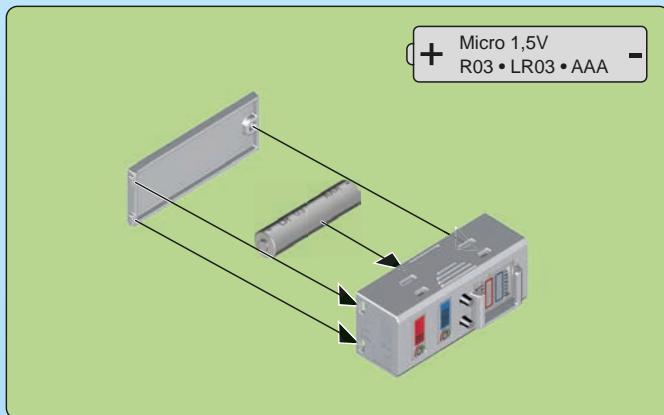

- (DE) (AT) (CH) (LU) (BE) **ACHTUNG!** Das Spielzeug erzeugt Lichtblitze, die bei empfindlichen Personen Epilepsie auslösen können.
- (US) (GB) (CA) (MT) (IE) **WARNING!** This toy produces flashes that may trigger epilepsy in sensitised individuals.
- (FR) (CA) (BE) (LU) (CH) **ATTENTION!** Ce jouet crée des flashes lumineux susceptibles de déclencher des crises d'épilepsie chez certaines personnes.
- (ES) (MX) **¡ADVERTENCIA!** El juguete genera destellos de luz que, en personas sensibles, pueden provocar epilepsia.
- (NL) (BE) **WAARSCHUWING!** het speelgoed veroorzaakt lichtflitsen, die bij gevoelige personen epilepsie kunnen veroorzaken.
- (IT) (CH) **AVVERTENZA!** Il giocattolo genera lampi di luce che possono provocare epilessia nei soggetti sensibili.
- (PT) **ATENÇÃO!** O brinquedo imite raios de luz que, em caso de pessoas sensíveis pode provocar epilepsia.
- (DK) **ADVARSEL!** Dette legetøj frembringer lysglimt, der kan fremprovokere epileptiske anfald hos særlig følsomme mennesker.
- (NO) **ADVARSEL!** Leketøyet fremkaller lynlys som kan utløse epilepsi hos ømfintlige personer.
- (SE) (FI) **VARNING!** Den här leksaken avger ljusblingar, som kan utlösa epilepsi hos känsliga personer.
- (FI) **VAROITUS!** Lelu välkkyy ja voi aiheuttaa epilepsia-kohtauksen herkimmillä henkilöillä.
- (HU) **FIGYELMEZTETÉS!** A játékszer fényfelvillanásokat okoz, amely az arra érzékeny személyeknél epilepsziás rohamokat válthat ki!
- (CZ) **UPOZORNĚNÍ!** Hračka vydává světelné záblesky, které mohou u citlivých osob vyvolat epilepsii.
- (EE) **HOIATUS!** Mänguasi tekitab valgusvälkatusi, mis võivad tundlikel inimestel vallandada epileptilisi hoogusid.
- (LV) **BRĪDINĀJUMS!** Rotaļlietai darbojoties, rodas gaismas zibšņi, kas var izraisīt epilepsijas lēkmi jutīgām personām.
- (LT) **ĮSPĖJIMAS!** Žaislas generuoja šviesos blyksnius, kurie jautriems asmenims gali sukelti epilepsiją.
- (SI) **OPOZORILO!** Igrača oddaja bliske, ki pri občutljivih osebah lahko lahko sprožijo epileptične napade.
- (SK) **UPOZORNENIE!** Hračka vytvára záblesky svetla, ktoré môžu u citlivých osôb vyvolať epilepsiu.
- (PL) **OSTRZEŻENIE!** Zabawka wytwarza błyski, które u osób wrażliwych mogą wywoływać napady epilepsji.
- (TR) (CY) **ΔΙΚΚΑΤ!** Oyuncak, hassas kişilerde epilepsi nöbetine neden olabilecek ışık flaşları oluşturmaktadır.
- (GR) (CY) **ΠΡΟΕΙΔΟΠΟΙΗΣΗ!** Το παιχνίδι παράγει αστραπιαίο φως που μπορεί να προκαλέσει επιληψία σε ευαίσθητα άτομα.
- (RO) **AVERTISMENT!** Jucăria produce pulsuri de lumină care pot declanșa crize de epilepsie la persoanele sensibile.
- (BG) **Внимание!** Игрчката произвежда светкавици, които могат да предизвикат епилепсия при чувствителни лица.
- (HR) **UPOZORENJE!** Igračka proizvodi bljeskove koji kod osjetljivih osoba mogu izazvati epilepsiju.
- (RU) **Внимание!** игрушка генерирует вспышки света, которые могут вызвать эпилептический припадок у чувствительных людей.
- (CN) **警告!** 本玩具产生闪光, 在敏感者有导致癫痫发作的可能。





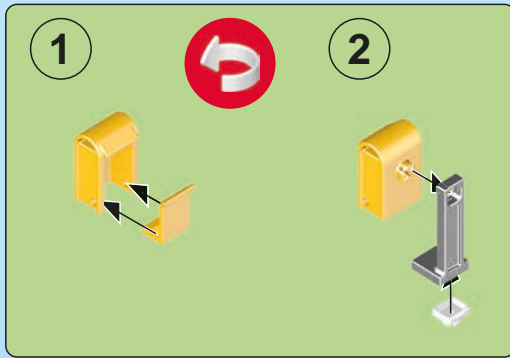
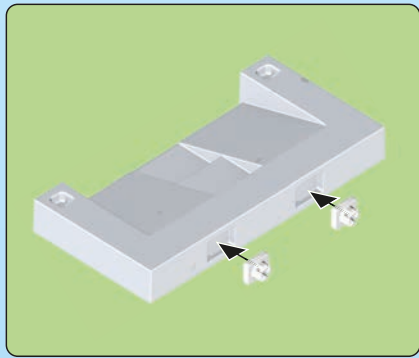

3

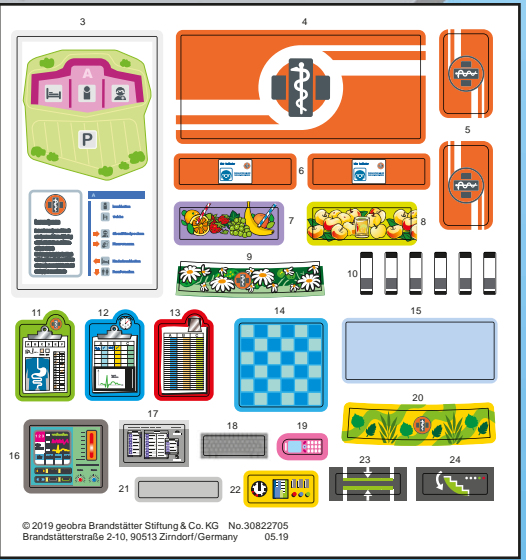
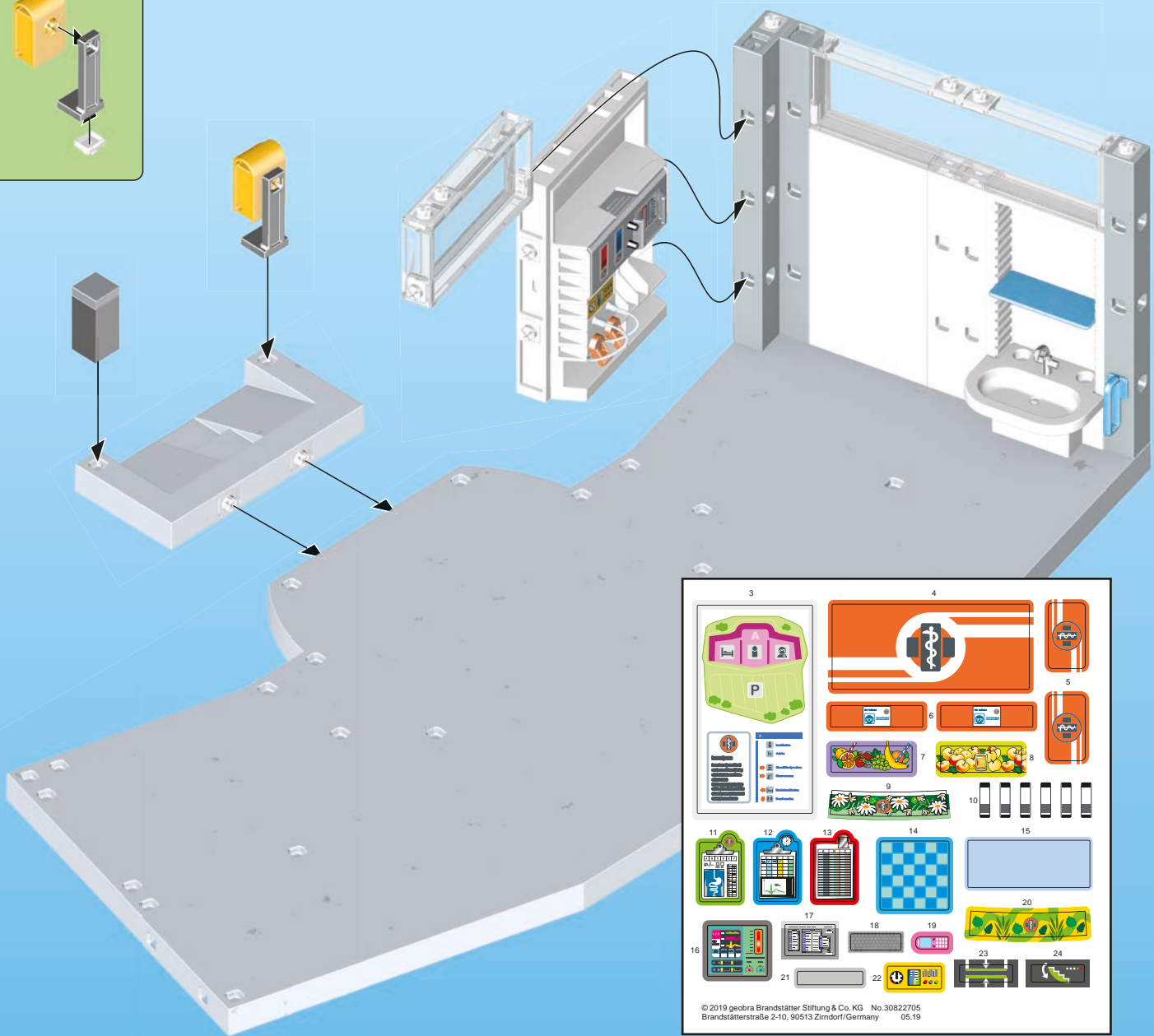
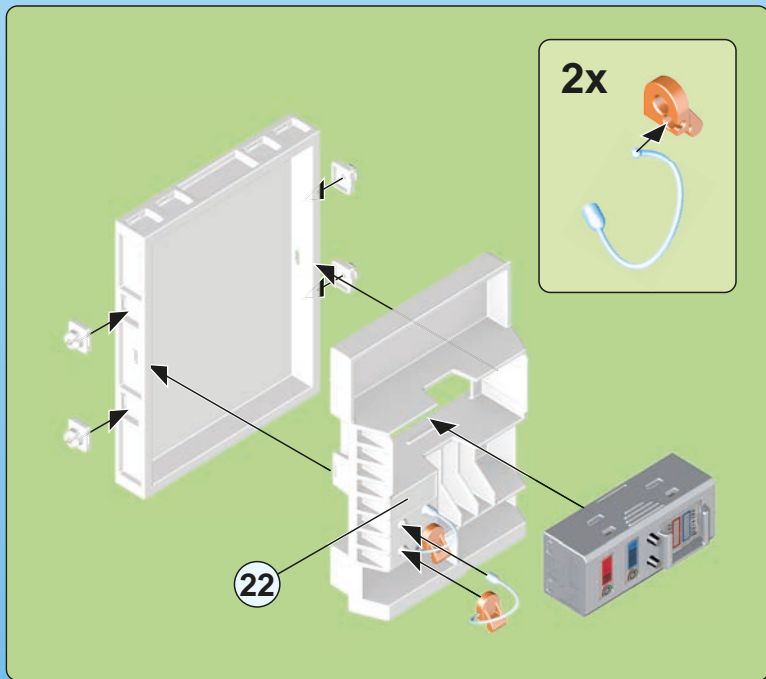
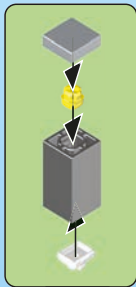
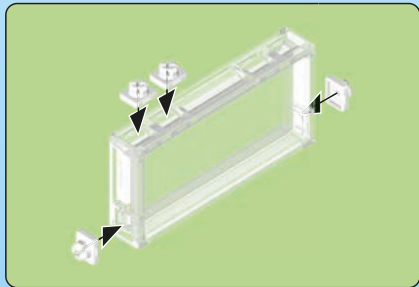

© 2019 geobra Brandstätter Stiftung & Co. KG No.30822705  
 Brandstätterstraße 2-10, 90513 Zirndorf/Germany 05.19



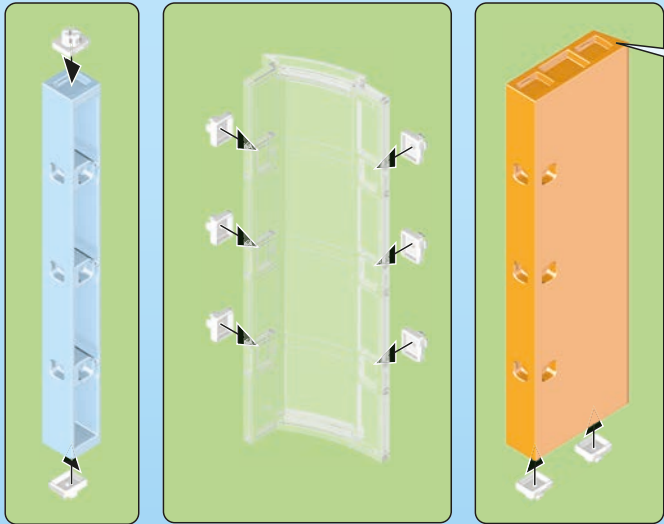

4

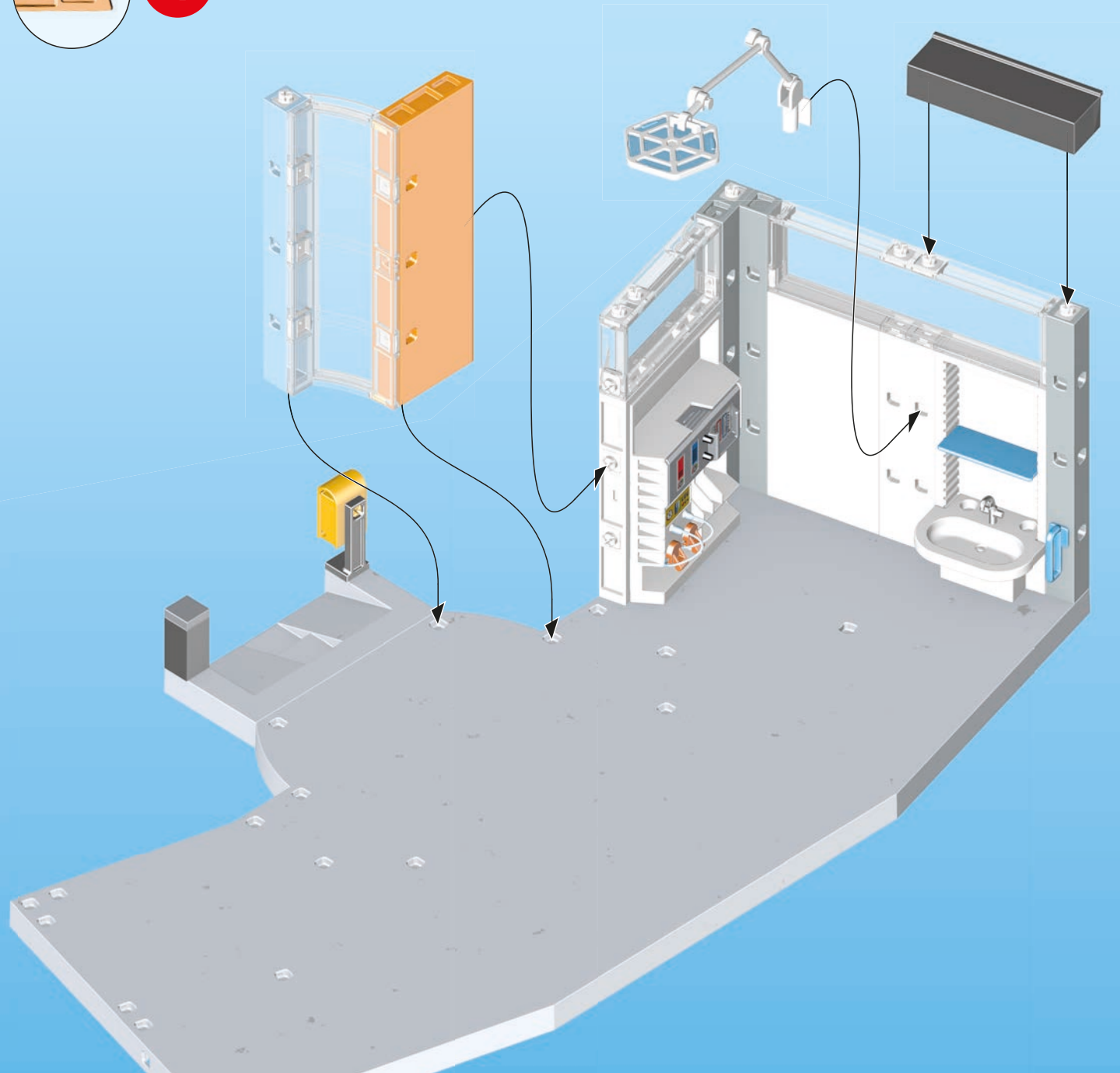
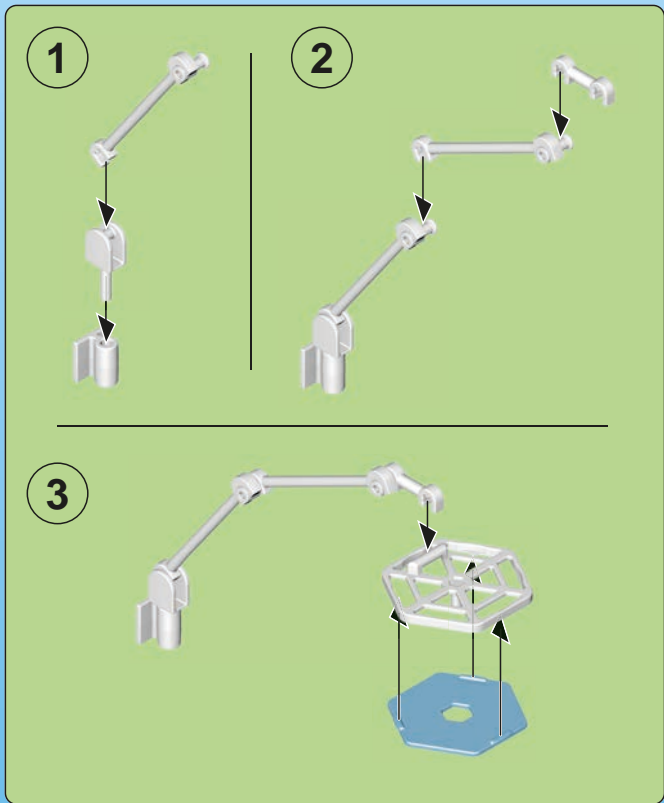



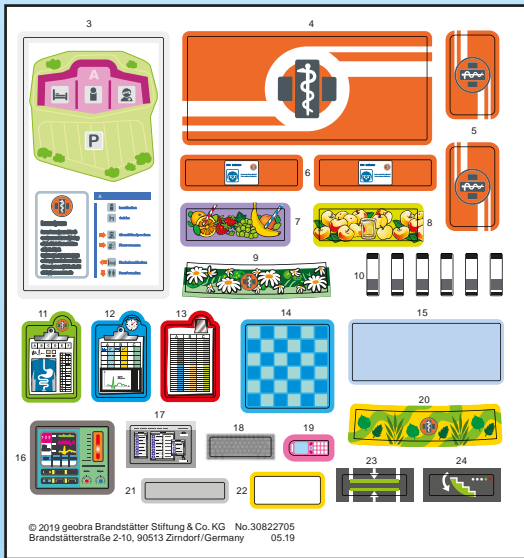

5

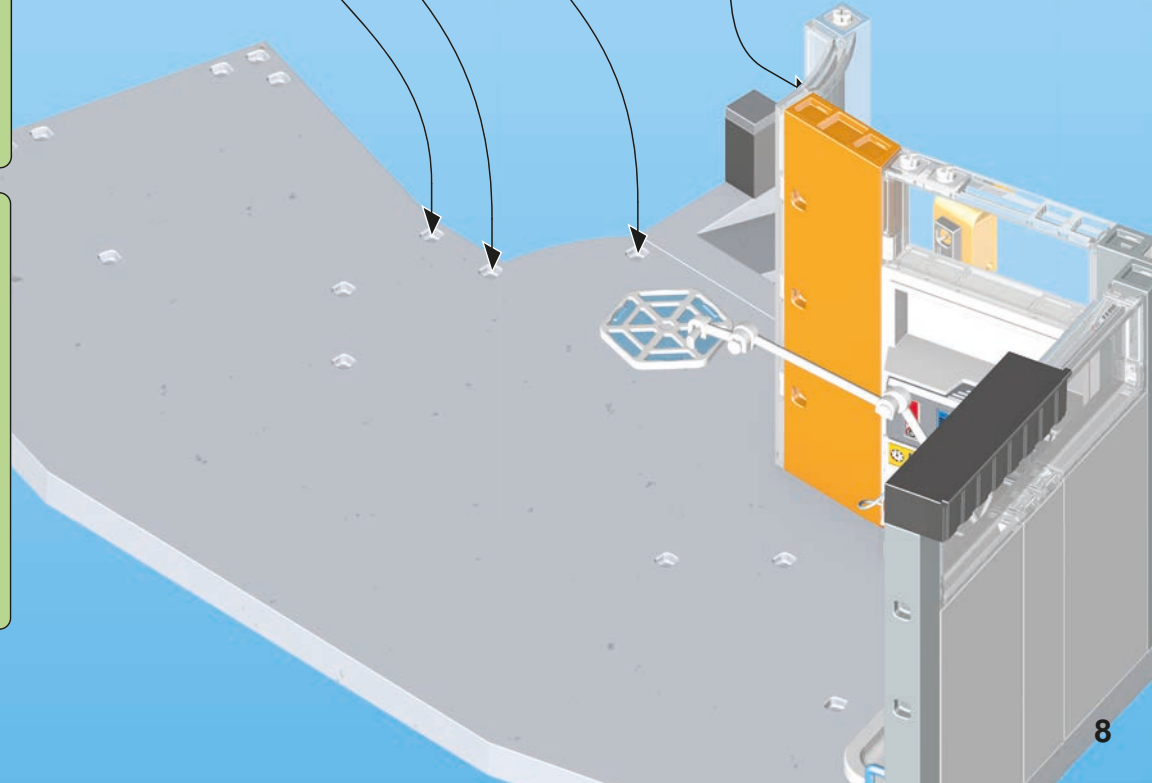
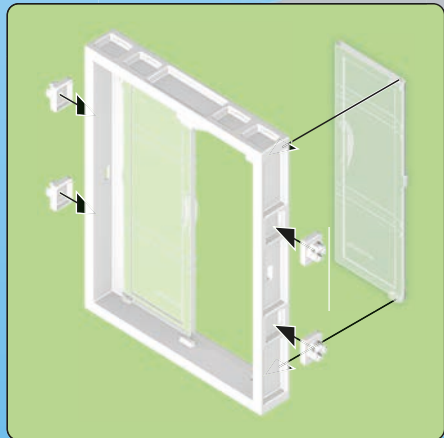
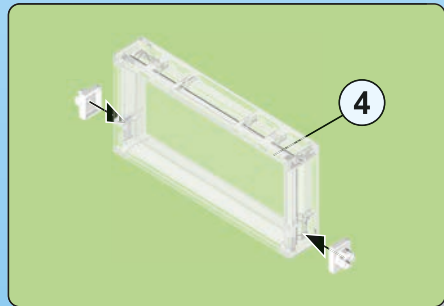
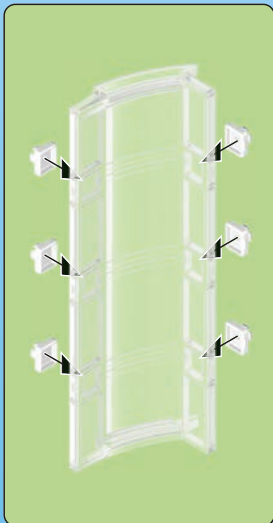
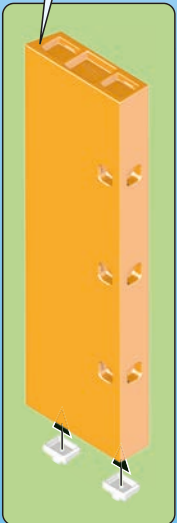
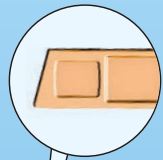
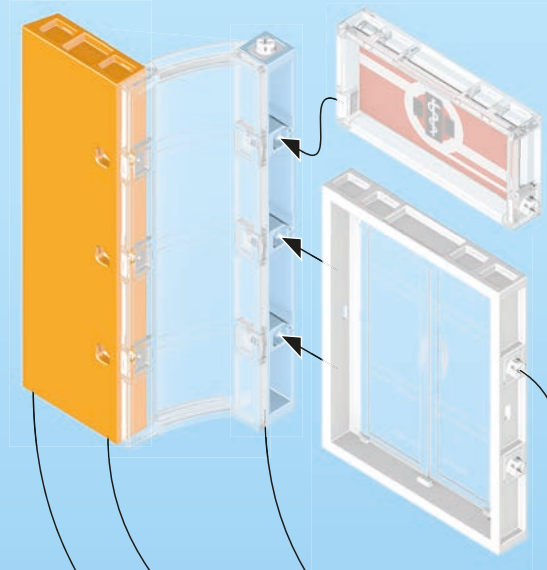

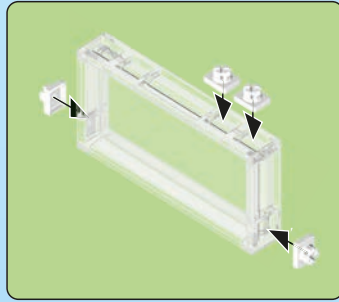
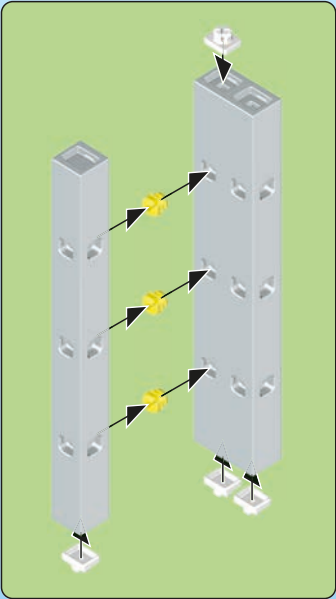

6

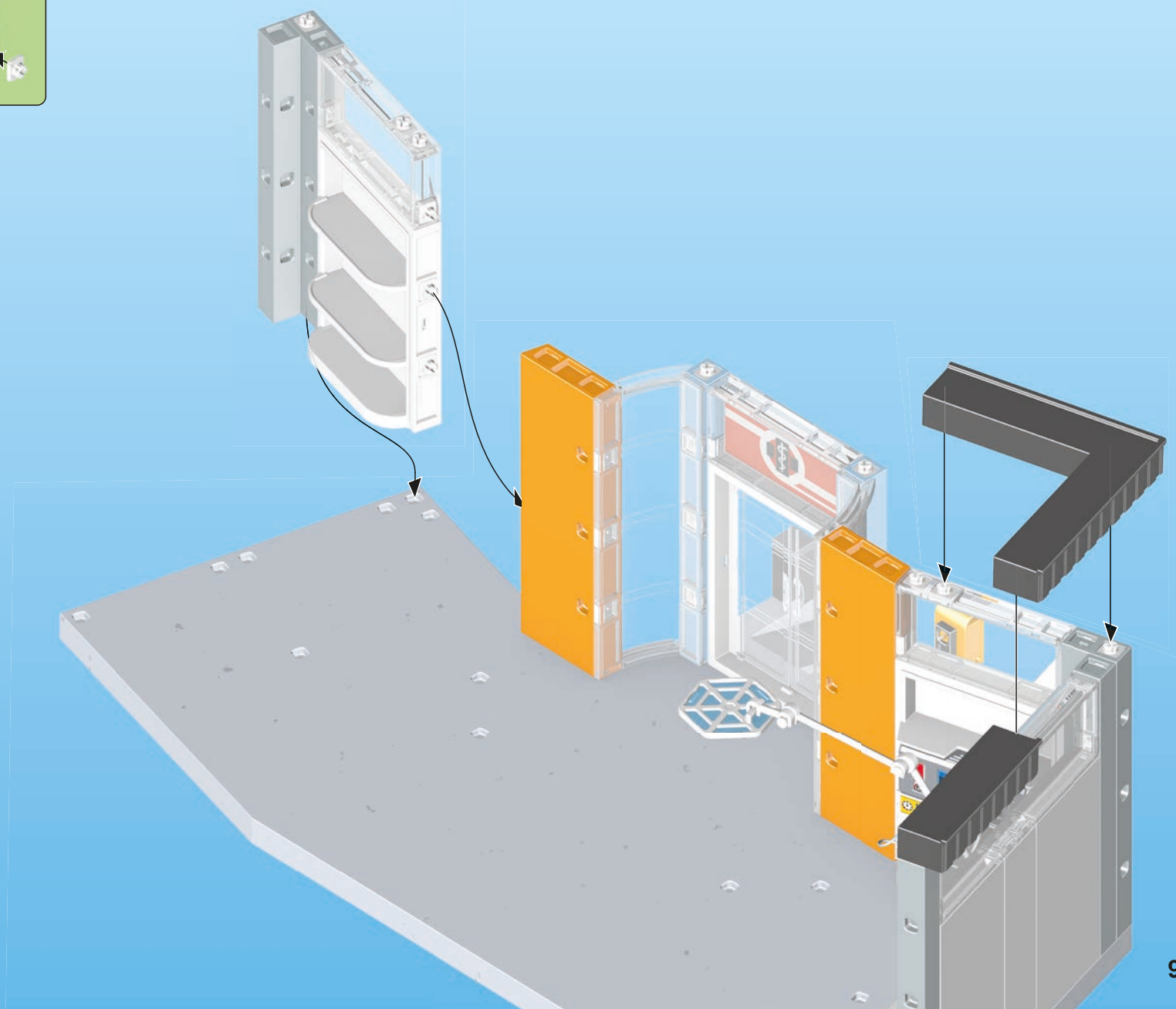
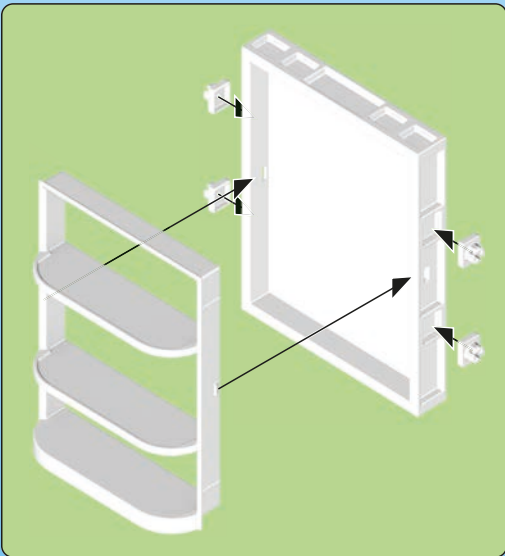

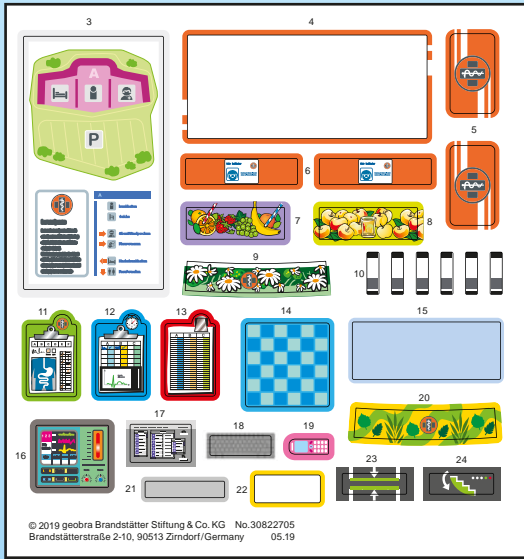

7

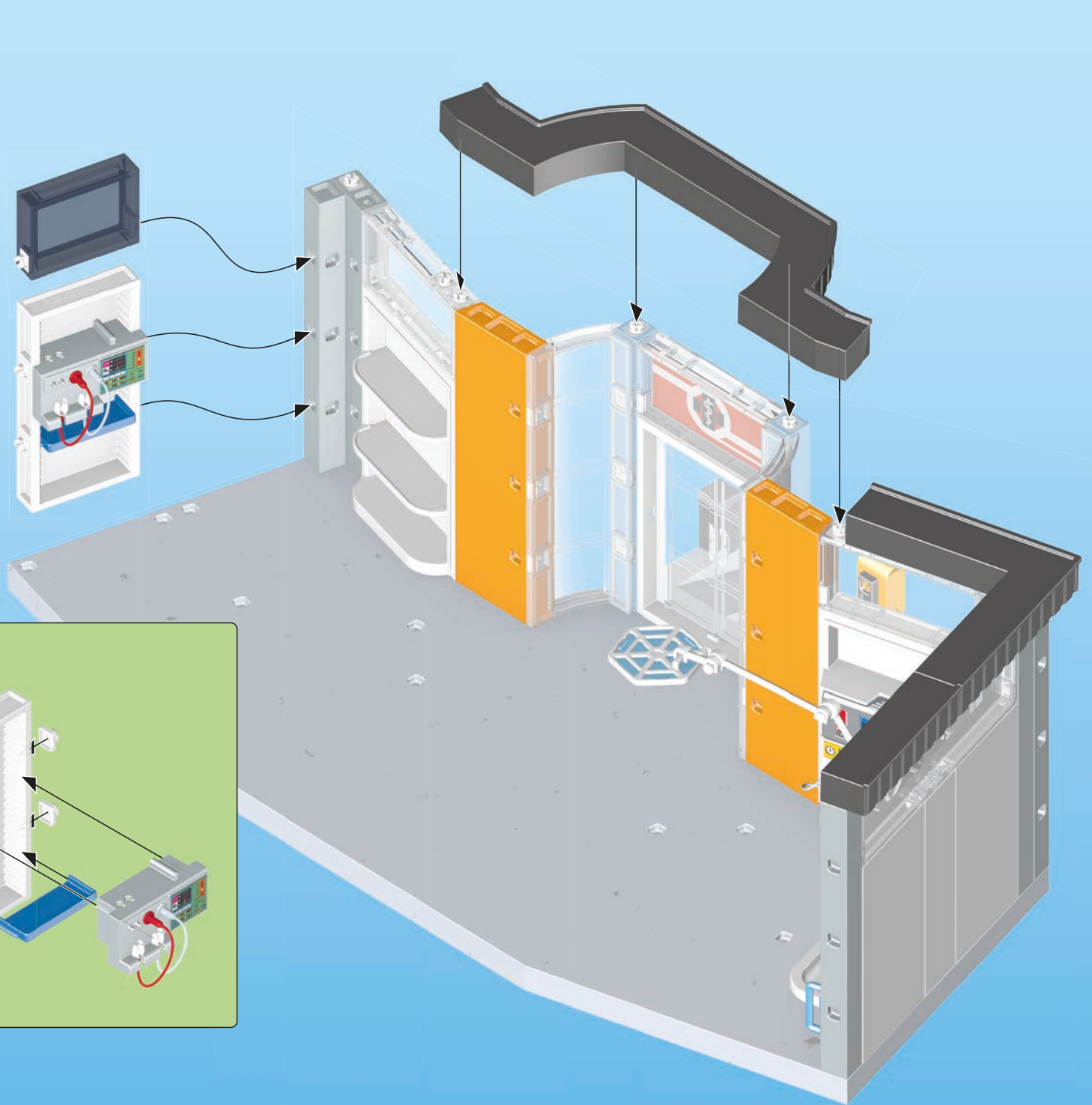
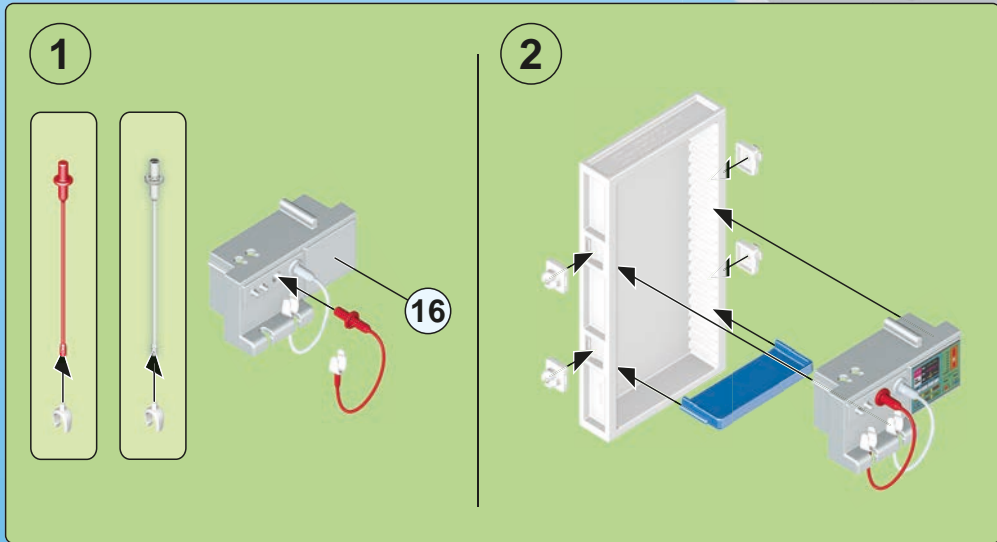
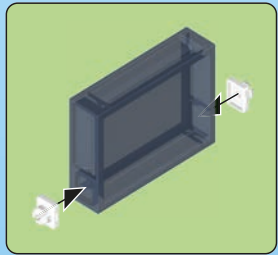



8

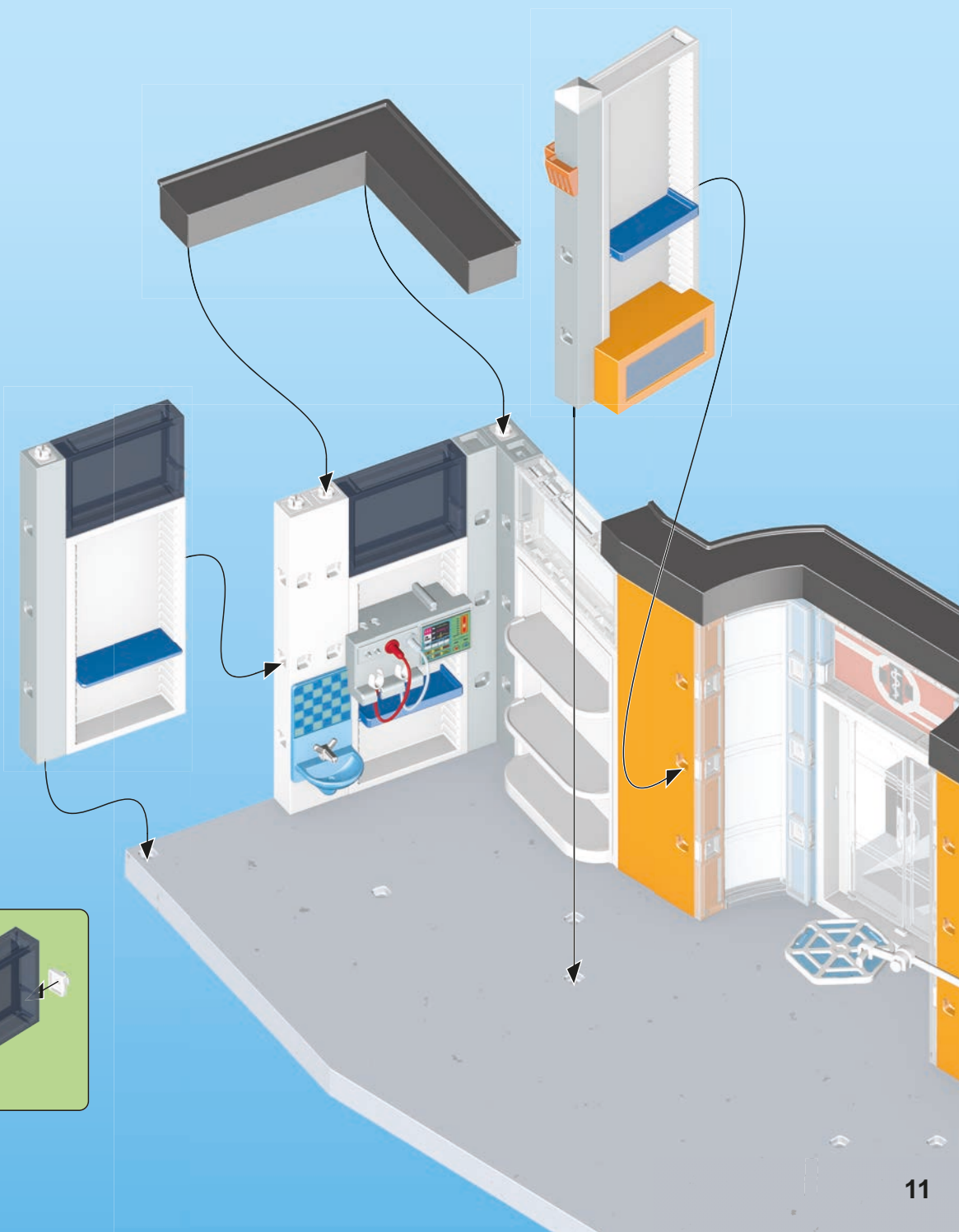
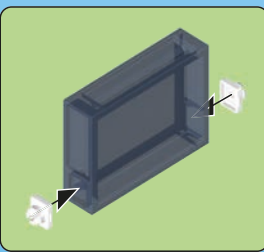
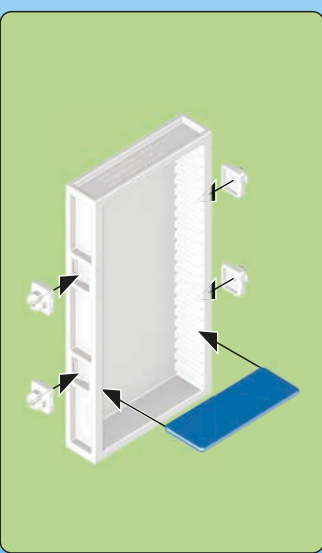
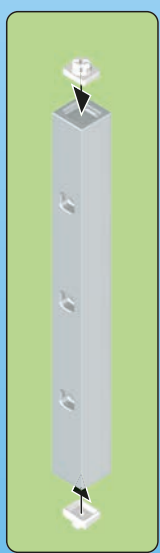
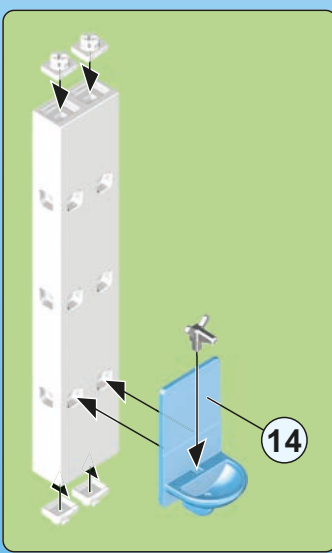
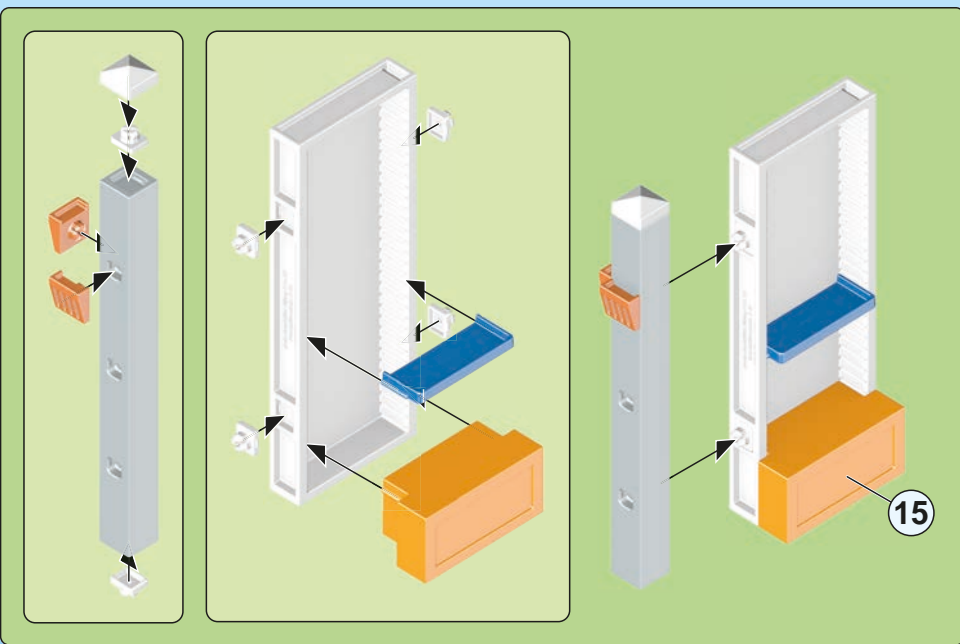

# 9

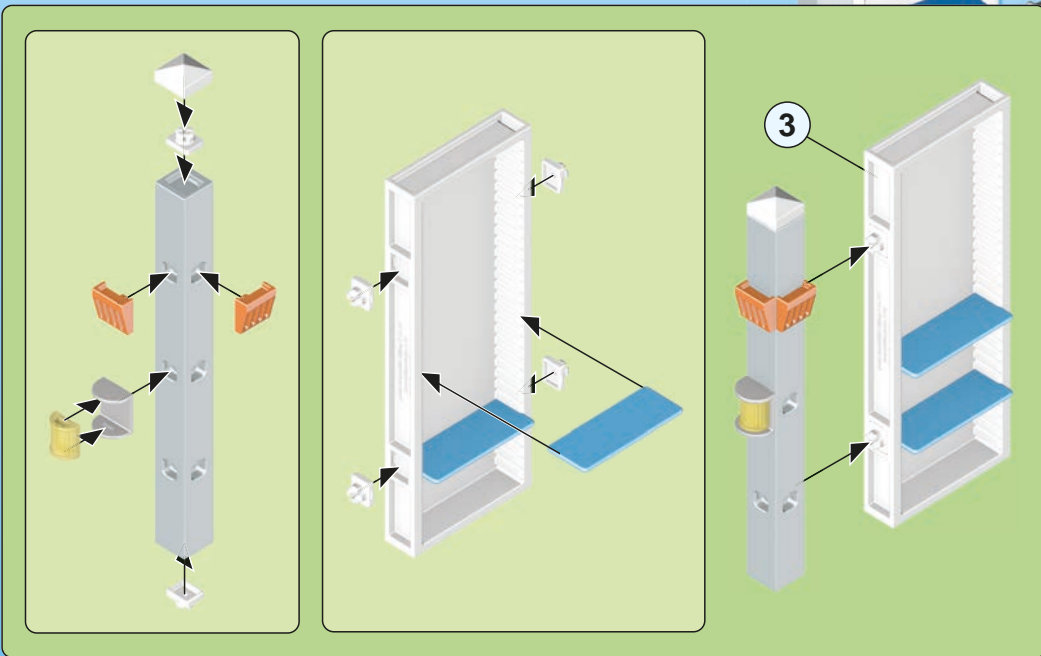
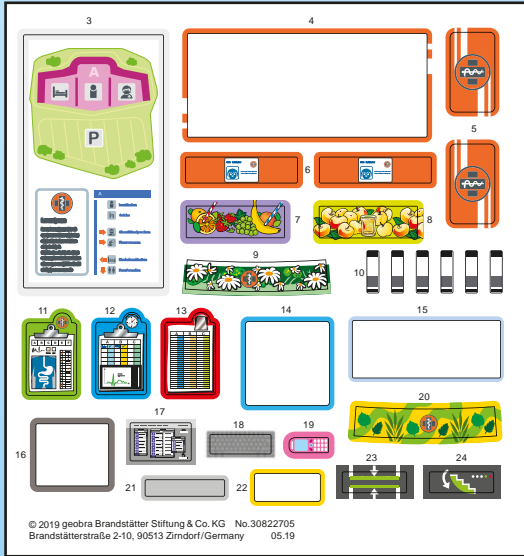

**1** 30 24 0783  
30 24 0763  
6  
30 24 0773  
30 23 9563

**2** 30 24 0793  
30 26 3940  
30 20 8430  
30 88 3522  
30 23 7163

**1** 6

**2**

**2x** 30 23 9203  
20 9  
30 22 0880

**2x** 2x 30 03 3550  
5

30 03 3850  
30 03 2380

**2x** 30 04 7803  
30 22 3393

**2x** 30 21 4020  
11 12

© 2019 geobra Brandstätter Stiftung & Co. KG  
Brandstätterstraße 2-10 No.30823505  
90513 Zimndorf/Germany 00.00

30 82 3505  
2 1  
2x 30 03 0403

30 21 1082  
30 24 0473  
21  
23 24  
30 24 0463  
30 22 2920

**4x** 10  
30 24 4730

17  
18  
30 66 8702

10  
30 24 4740

13  
30 20 0590

10  
30 29 1660

7  
30 04 7992

30 20 1262  
30 20 2082

30 28 8680  
30 28 8690

30 22 2120  
30 22 0890

30 82 3163

19  
30 25 1502

8  
30 22 5800





30 00 5224

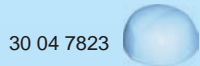

30 14 2362

30 04 4850



30 60 0752



30 14 2372



30 61 0542



30 00 5234

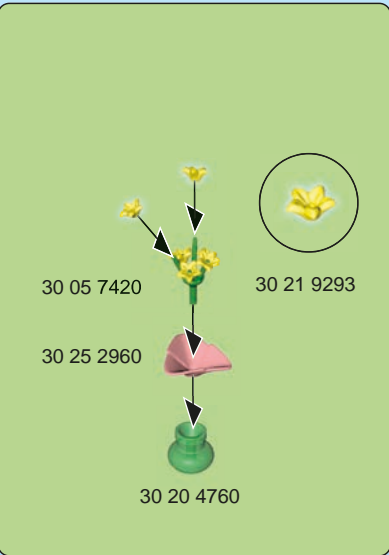
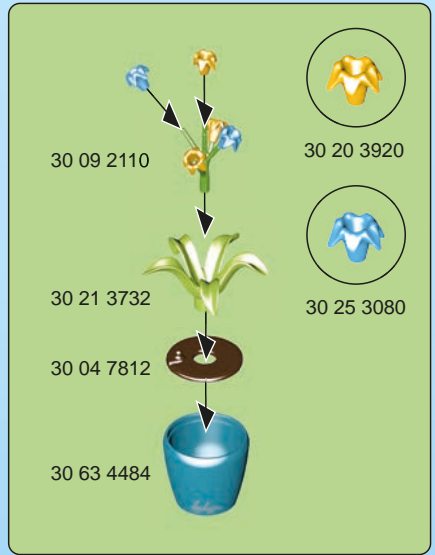

2x 30 04 7853



2x 30 65 2704



2x 30 25 4543



2x 30 03 3892



30 25 3173



30 66 6610



3x 30 24 3940

30 82 2705

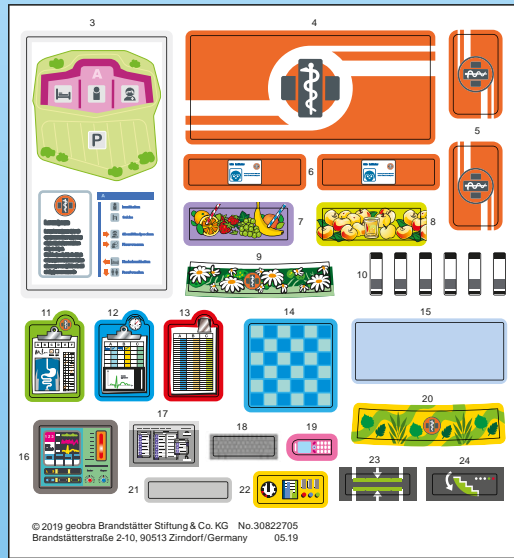

© 2019 geobra Brandstätter Stiftung & Co. KG No.30822705 Brandstätterstraße 2-10, 90513 Zirndorf/Germany 05.19

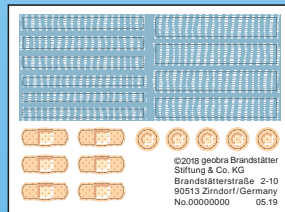

© 2018 geobra Brandstätter Stiftung & Co. KG Brandstätterstraße 2-10 90513 Zirndorf/Germany No.00000000 05.19

30 82 9492



US

This device complies with Part 15 of the FCC Rules. Operation is subject to the following two conditions: (1) This device may not cause harmful interference, and (2) this device must accept any interference received, including interference that may cause undesired operation.

CA

CAN ICES-3 (B)/NMB-3(B) Cet équipement est conforme à la Section 15 des règlements de la FCC. Son fonctionnement est soumis aux deux conditions suivantes: (1) Cet équipement ne peut causer d'interférence nuisible, et (2) cet équipement doit pouvoir fonctionner même s'il capte de l'interférence, incluant celle pouvant provoquer un fonctionnement indésirable.

US

NOTE: This equipment has been tested and found to comply with the limits for a Class B digital device, pursuant to part 15 of the FCC Rules. These limits are designed to provide reasonable protection against harmful interference in a residential installation. This equipment generates, uses and can radiate radio frequency energy and, if not installed and used in accordance with the instructions, may cause harmful interference to radio communications. However, there is no guarantee that interference will not occur in a particular installation. If this equipment does cause harmful interference to radio or television reception, which can be determined by turning the equipment off and on, the user is encouraged to try to correct the interference by one or more of the following measures: - Reorient or relocate the receiving antenna. - Increase the separation between the equipment and receiver. - Connect the equipment into an outlet on a circuit different from that to which the receiver is connected. - Consult the dealer or an experienced radio/TV technician for help.

PLAYMOBIL USA, INC. 26 Commerce Drive Cranbury, NJ 08512 Phone 1-800-752-9662 or 609-395-5566 Email: service@playmobilusa.com

Caution: Changes or modifications not expressly approved by the party responsible for compliance could void the user's authority to operate the equipment.

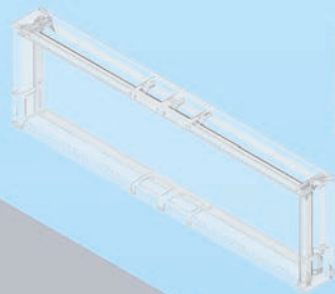
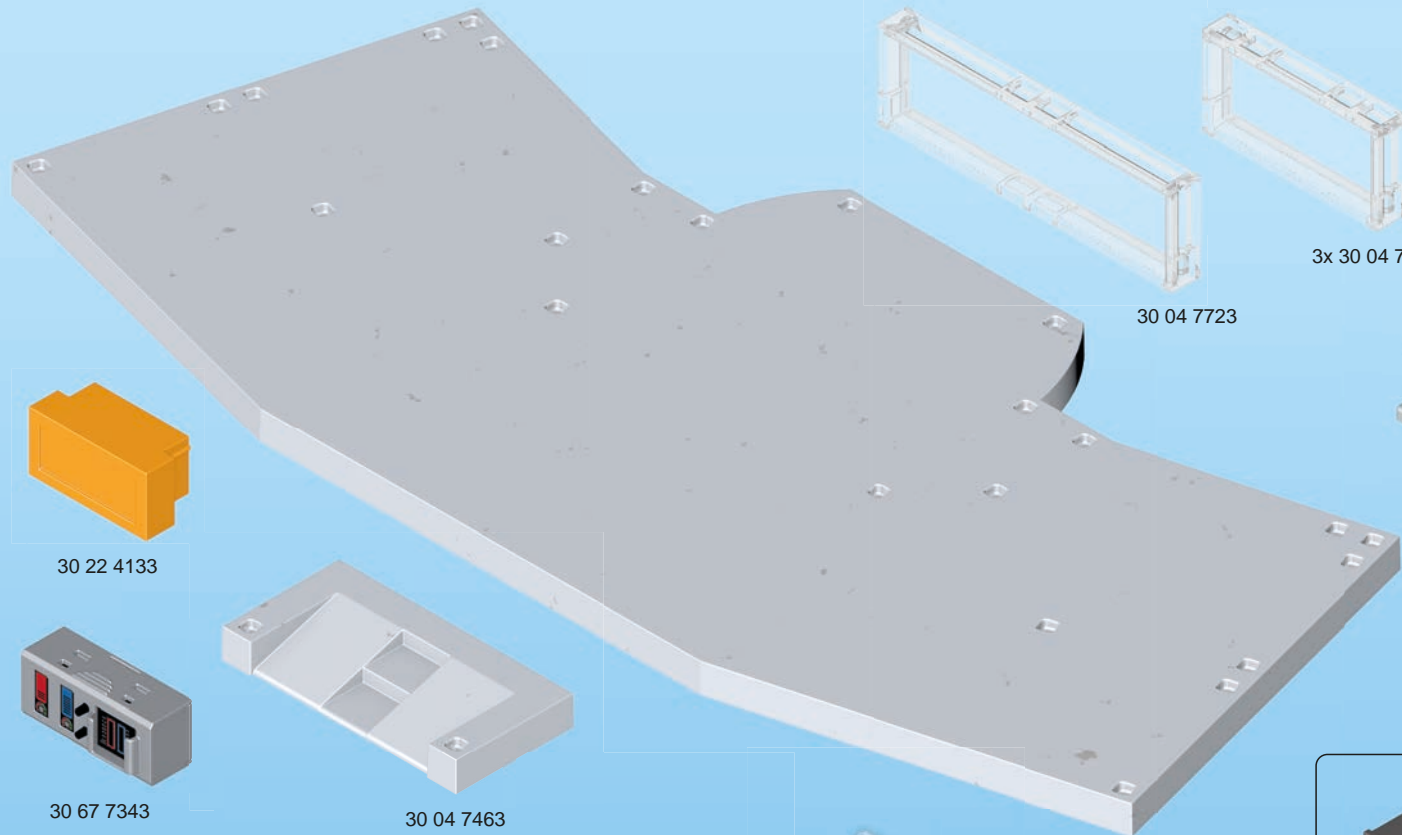

30 04 7723

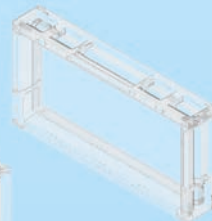

3x 30 04 7733

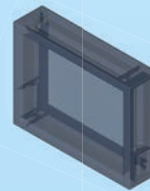

2x 30 20 2922



6x 30 04 7483



30 66 7780



2x 30 65 2734

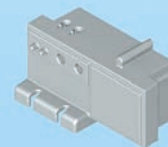

30 26 9790



30 25 1482



30 04 7643



30 26 9620



30 22 4133



30 67 7343



30 04 7463



30 82 2992



30 88 3522



2x 30 03 0623



30 04 7653



2x 30 25 4483

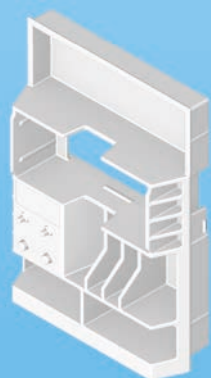

30 04 7673



30 25 4513



30 66 7770



30 51 3162

30 04 7693

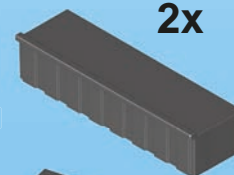

2x

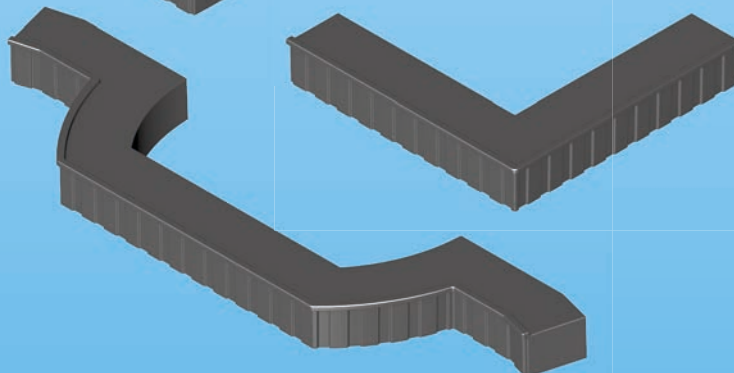

2x

30 51 9352



**DE AT CH LU BE** Denken Sie an den Schutz der Umwelt !  
 - Ihr Gerät enthält wertvolle Rohstoffe, die wieder verwertet werden können.  
 - Geben Sie Ihr Gerät deshalb bitte bei einer Sammelstelle Ihrer Stadt oder Gemeinde ab.

**GB MT IE** Environment protection first !  
 - Your appliance contains valuable materials which can be recovered and recycled.  
 - Leave it at a local civic waste collection point.

**FR LU CH** Participons à la protection de l'environnement !  
 - Votre appareil contient de nombreux matériaux valorisables ou recyclables.  
 - Confiez celui-ci dans un point de collecte pour que son traitement soit effectué.

**ES** ¡¡ Participe en la conservación del medio ambiente !!  
 - Su electrodoméstico contiene materiales recuperables y/o reciclables.  
 - Entréguelo al final de su vida útil, en un Centro de Recogida Específico o en uno de nuestros Servicios Oficiales Post Venta donde será tratado de forma adecuada.

**NL BE** Samen het milieu beschermen !  
 - Uw product bevat meerdere recycleerbare materialen  
 - Breng deze naar een afval-inzamelpunt.

**BE** Participons à la protection de l'environnement !  
 - Votre appareil contient de nombreux matériaux valorisables ou recyclables.  
 - Entrégué celui-ci dans un point de collecte ou à défaut dans un centre service agréé pour que son traitement soit effectué.

**IT CH** Partecipiamo alla protezione dell'ambiente !  
 - Il vostro apparecchio è composto da diversi materiali che possono essere riciclati.  
 - Lasciatelo in un punto di raccolta o presso un Centro Assistenza Autorizzato.

**PT** Protecção do ambiente em primeiro lugar!  
 - O seu produto contém materiais que podem ser recuperados ou reciclados.  
 - Entregue-o num ponto de recolha para possibilitar o seu tratamento.

**DK** Vi skal alle være med til at beskytte miljøet!  
 - Apparatet indeholder mange materialer, der kan genvindes eller genbruges.  
 - Bring det til et specialiseret indsamlingssted for genbrug eller et autoriseret serviceværksted, når det ikke skal bruges mere.

**SE FI** Var rädd om miljön!  
 - Din apparat innehåller olika material som kan återanvändas eller återvinnas.  
 - Lämn den på en återvinningsstation eller på en auktoriserad serviceverkstad för omhändertagande och behandling.

**FI** Huolehtikaamme ympäristöstä!  
 - i Laitteesi on varustettu monilla arvokkailla ja kierrätettävillä materiaaleilla.  
 - Toimita laitteesi keräyspisteeseen tai sellaiseen puuttuessa vaikka valtuutettuun huoltokeskukseen, jotta laitteen osat varmasti kierrätetään.

**HU** Első a környezetvédelem!  
 - Az Ön terméke értékes újrahasznosítható anyagokat tartalmaz.  
 - Kérjük készülékét ne dobja ki, hanem adja le az erre a célra kijelölt gyűjtőhelyen.

**CZ** Podílejme se na ochraně životního prostředí!  
 - Váš přístroj obsahuje četné vhodnotitelné nebo recyklovatelné materiály.  
 - Svrťte jej sběrnému místu nebo, neexistuje-li, smluvnímu servisnímu středisku, kde s ním bude naloženo odpovídajícím způsobem.

**SI** Sodelujmo pri varovanju okolja!  
 - Vaš aparat vsebuje številne dele, ki imajo svojo vrednost ali jih je še mogoče uporabiti.  
 - Oddajte ga na mestu za zbiranje odpadkov ali pa na pooblaščenem servisu, da bo šel v predelavo.

**SK** Podieľajme sa na ochrane životného prostredia!  
 - Váš prístroj obsahuje četné vhodnotitelné alebo recyklovateľné materiály.  
 - Zverte ho sběrnému miestu alebo, ak neexistuje, zmluvnému servisnému stredisku, kde s ním bude naložené zodpovedajúcim spôsobom.

**PL** Bierzmy czynny udział w ochronie środowiska!  
 - Twoje urządzenie jest zbudowane z materiałów, które mogą być poddane ponownemu przetworzeniu lub recyklingowi.  
 - W tym celu należy je dostarczyć do wyznaczonego punktu zbiórki.

**GR CY** Ας συμβάλουμε κι εμείς στην προστασία του περιβάλλοντος!  
 - Η συσκευή σας περιέχει πολλά αξιοποιήσιμα ή ανακυκλώσιμα υλικά.  
 - Παραδώστε την παλιά συσκευή σας σε κέντρο διαλογής ή σε ένα εξουσιοδοτημένο κατάστημα σέρβις.

**RO** Țineți cont de protecția mediului !  
 - Aparatul dvs. conține materii prime valoroase care pot fi revalorificate.  
 - Din acest motiv vă rugăm să predați aparatul dvs. la un centru de colectare din orașul sau comuna dvs.

**BG** Мислете за околната среда !  
 - Вашият уред съдържа ценни суровини, които могат да бъдат рециклирани.  
 - Затова върнете своя електроуред на специално място за събиране на такива отпадъци във Вашия град или община.

**RU** Подумайте о защите окружающей среды !  
 - Ваше устройство содержит ценное сырье, которое может быть переработано.  
 - Поэтому, пожалуйста, верните ваше устройство в пункт сбора в вашем городе или муниципалитете.

Abbildungen können vom Original abweichen. / Product may differ from image shown.  
 Les illustrations peuvent différer de l'original. / Afbeeldingen kunnen verschillen van het werkelijke artikel.

© 2019 geobra Brands ätter Stiftung & Co.GG  
 Brands ätters r. 2-10  
 90513 Zimdorf, Germany.  
 No. 30 82 5375 02.21



www.playmobil.com